

LED Panel

Instruction

To dear customers:

Thank you for purchasing PROTEC products, please read this instruction carefully before installation and usage, and please keep it for future reference.

I. Notice to users

1. Only qualified electrician is allowed to do the installation, maintenance and inspection for safety concern.
2. Do not install the product in high temperature or high humidity place.
3. Please turn off the power before installation and maintenance. The usage of this products should comply with the local laws.
4. Please turn off the power promptly if any abnormal happens, and contact with our retailers by providing the product model.
5. The luminaire should not be covered by any thermal insulation materials.
6. The external flexible cable or cord of this luminaire cannot be replaced; if the cord is damaged, the luminaire shall be destroyed.
7. Installation accessories not included. Installation may require advice from qualified person.
8. LED module is not replaced.

II. Installation instruction

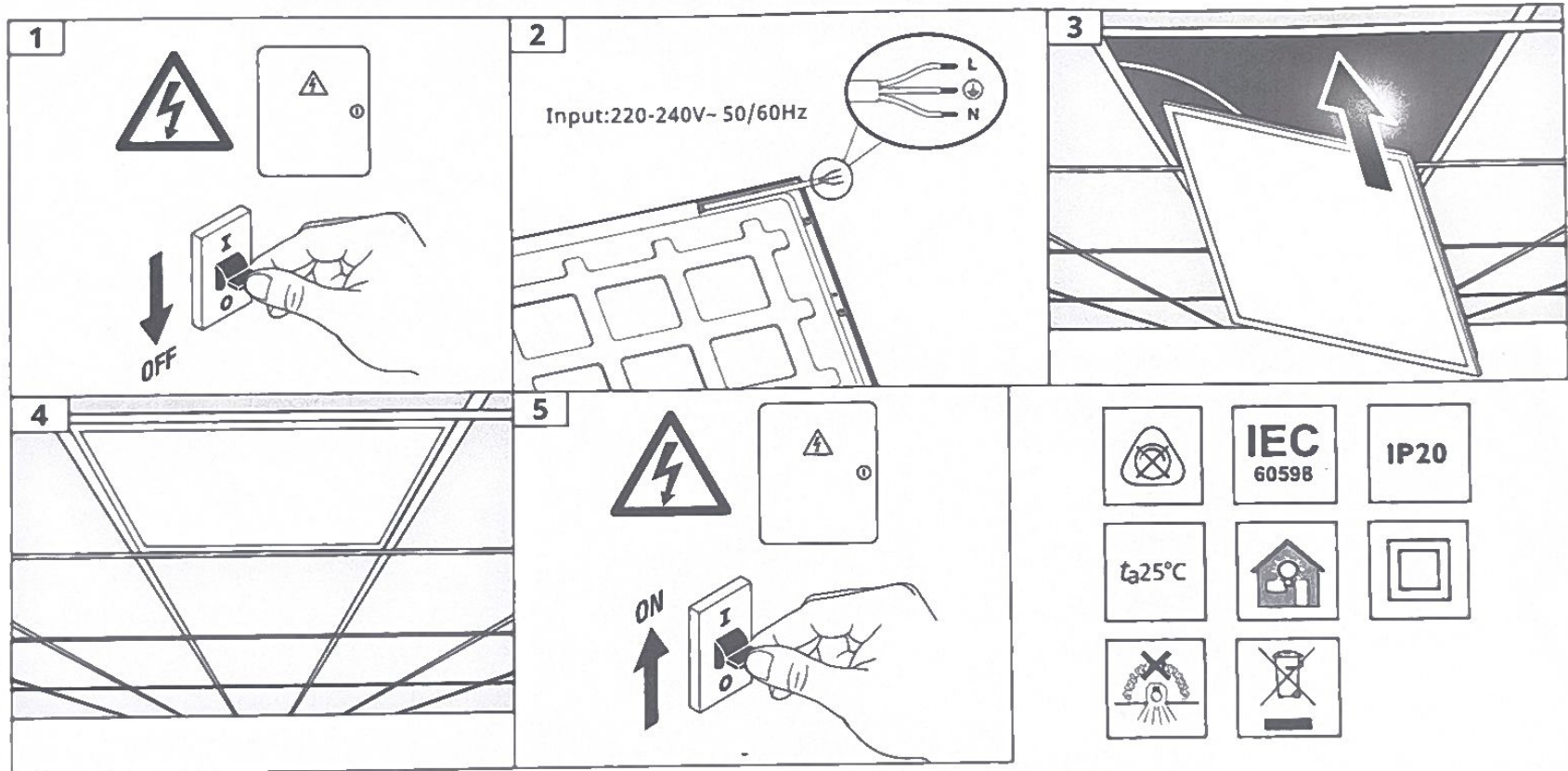

III. Product parameters (unit:mm)

Code	Dimension(mm)	Rated Volt	Power	CCT
PLFM-LED-6060-40W	595×595	220-240V~ 50/60Hz	40W	3000K
				4000K
				6500K

IV. Warning

1. Power should be cut off before installation, maintenance or inspection.
2. Please install and use the light strictly according to the instruction.
3. Do not disassemble or remold the product at will to avoid accident of electric shock or light falling.

The light source in this product cannot be replaced. At the end of its service life, it is necessary to replace the entire product. Installation must be made by a qualified person.



This marking indicates that this product should not be disposed with other household wastes throughout the EU. Return the used device, please use the return and collection system or contact the retailer where the product was purchased.